



Tool Boxes and Roller Cabinets

INSTRUCTIONS

1. PREPARING THE TOOL CHEST

1.1 LOCKING DRAWERS - FIG. 1

Boxes that have no front locking panel are equipped with a locking mechanism actuated by the lid. When the lid is closed, tabs in the lock bar engage the back of the drawers. When the lid is opened, the tabs are raised clear.

IMPORTANT: The drawers must be fully closed before the lid is shut. **DO NOT** slam the drawers when the lid is shut; as they will not lock and damage the lock bar tabs or draw back may occur. Should this happen, remove the drawer and straighten out the deformed tab with a screwdriver. For the draw backs, a pair of pliers should be used.

1.2 REMOVAL/RE-INSTALLATION OF DRAWERS - FIG. 2

To remove, pull drawer fully open. Push the plastic level (2) on both sides to release drawer from slides. Pull the drawer out.

To re-install, line up the drawer slides, engage, and close the drawer completely.

FIG.1

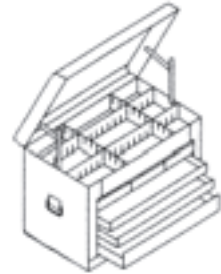
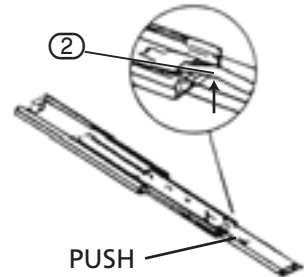

FIG.2



1.3 ROLLER CABINETS

The roller cabinets feature a rotating cam lock mechanism controlled by a key. When locked, hooks engage in each drawer to prevent them from being opened. If the cabinet is locked while the drawers are still open, unlock the cabinet, close drawer and re-lock.

1.4 CASTORS AND SIDE TRAY - FIG. 3

Use the screws included to attach the two heavy-duty fixed castors (3A) and two heavy-duty swivel castors with brakes (3B) as shown in the diagram. The side handle (3C) must be attached to the same side as the swivel castors.

FIG.3

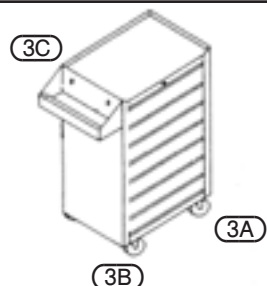

1.5 LUBRICATION - FIG. 4

To ensure smooth operation of the slides, lubricate them periodically with a light grease. Do this at least twice a year or more, depending on the frequency of use.

FIG.4

